

# PROJECTS MAGAZINE

APRIL MAY 2025 ISSUE



**GAHIR ENGINEERING WORKS LTD**  
MECHANICAL ENGINEERS & MANUFACTURERS



**Cone Crusher**



**Jaw Crusher**

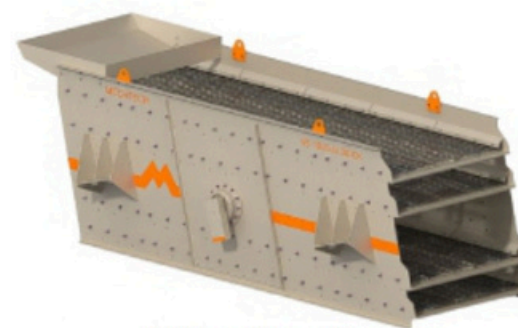

**Vibrating Screen**



**Washing System**

P.O. BOX 78252-00507, NAIROBI  
TEL: 020-3540428/020-2042837  
MOBILE: 0722510237/0722510238  
INDUSTRIAL AREA, PATE ROAD OFF LUNGA LUNGA  
E-MAIL: [info@gahirdesco.co.ke](mailto:info@gahirdesco.co.ke)  
WEBSITE: [www.gahirdesco.co.ke](http://www.gahirdesco.co.ke)

Suppliers of  
**MECHTECH**  
**INFRAMINE**  
Quality Products

*Your Dependable Partner*



**DE LEEUW**  
GROUP  
QUANTITY SURVEYORS



**Offices**  
Bloemfontein  
Cape Town  
Dubai  
Durban  
Johannesburg  
Nigeria  
Pietermaritzburg  
Pretoria  
Qatar  
Rustenburg  
Saudi Arabia  
Stellenbosch  
Windhoek

**RECEIVED AN AWARD  
FROM THE GREEN BUILDING COUNCIL**

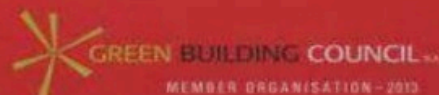

SCAN ME

[www.deleeuwgroup.com](http://www.deleeuwgroup.com)

branding | gestudio.co.za



Tel: +27 (0)16 986 0030  
Fax: +27 (0)16 986 0127  
e-mail: [rfq@turnmill.co.za](mailto:rfq@turnmill.co.za)

[www.turnmill.co.za](http://www.turnmill.co.za)

12 Fairbank Street NW7  
Vanderbijlpark, 1911  
PO Box 2092, Vereeniging, 1930

**TURNMILL**  
PROQUIP ENGINEERING (PTY) LTD

**Fabrication and reconditioning specialists**

*Turnmill is a level 1 BBBEE contributor*

- Pressure Vessels: Columns, Shell & Tube Heat, Exchangers and Drums
- Shop Fabricated Tanks
- Rotary Kilns and Processed Fired Equipment
- Materials Handling and Structural Components
- Rotable Unit Repairs and Refurbishment
- Mill Components and Spares
- CNC Turning
- Large 5 Axis CNC Milling (manually adjusted 6th Axis)



**STRUCTA**  
group  
Turnmill is an ISO 9001:2015  
and an ISO 3834 Part 2 Certified  
Company  
Part of the STRUCTA GROUP of Companies

**WOOTA PUBLISHERS T/A Projects Magazine P.O.BOX 178--20114 KABAZI, NAKURU, KENYA**

**Nakuru Office**

**Call Us: +254 758 235 164**

**: [info@projectsmagazine.co.ke](mailto:info@projectsmagazine.co.ke)**

**Website: [www.projectsmagazine.co.ke](http://www.projectsmagazine.co.ke)**

**Mon – Fri: 9:00 AM–5:00 PM**

**Ol'kalou Office**

**Kanyiriri, Ol'kalou, Kenya Call us : +254 745 385 165**

**Mon – Fri: 9:00 AM–5:00 PM**

**Uganda Agent**

**Hawk Eye Technologies**

**Tel: +256 752 520 158 Plot. 6 Entebbe Road, Kampala, Central, 00256, Uganda**

**South Africa's Office**

**MOUNT EVEREST PUBLISHER (PTY) LTD**

**Tel: +27 78 692 0826 Fax: +27 86 601 9195**

**Mon – Fri: 9:00 AM–5:00 PM**

**Contributions**

**The editors welcome news items, press releases, articles, and photographs relating to the Mining Industry. These will be considered and, if accepted, published. No responsibility will be accepted should contributions be lost, damaged, or incorrectly printed.**

**© All rights reserved**



# Tower Cost Consultants Limited: Crafting the Future of East Africa's Built Environment



In the ever-evolving skyline of East Africa, where glass towers and luxury estates rise from the fertile grounds of ambition, Tower Cost Consultants Limited (TCCL) stands tall as a pillar of precision, professionalism, and progress.

From its humble beginnings in Nairobi in 2000, the firm has grown into a regional powerhouse, shaping over 1 million square meters of transformative spaces across Kenya and Tanzania and setting its sights on an even broader African footprint—enriching African life spaces by providing eminent construction consultancy services.

As East Africa's construction sector surges toward a projected \$73 billion valuation by 2028, TCCL is not just participating in this boom—it is helping to lead it.

## Foundations of Integrity

At the heart of TCCL's journey is a simple yet profound philosophy: "Consultancy without compromise." When founder Joseph Kungu, a seasoned quantity surveyor, established the firm at the dawn of the millennium, he envisioned a consultancy built on integrity, transparency, and enduring value. This ethos remains the bedrock of TCCL's operations today.

In 2012, the firm helped bring to life the Billionaire Resort & Retreat in Malindi, a crown jewel on the Kenyan coast. By 2018, TCCL had completed the opulent One General Mathenge apartments in Nairobi's affluent Westlands. Most notably, in 2020, the company was part of the elite team behind the cost planning of 88 Nairobi Condominium, now the tallest residential building in Africa.



## Expertise Across the Lifecycle

What sets TCCL apart is its mastery across every stage of the construction lifecycle. From initial feasibility studies and dynamic budget planning to transparent tender management and meticulous cost auditing, TCCL ensures that no detail is left to chance.







"Every project we undertake is more than just a contract—it's a legacy," Kungu affirms. The firm's unwavering dedication to its core values of integrity, passion, professionalism, and reliability has cemented its reputation as a trusted advisor in the construction industry. Over the years, TCCL has delivered iconic projects that have redefined luxury and innovation in the region.

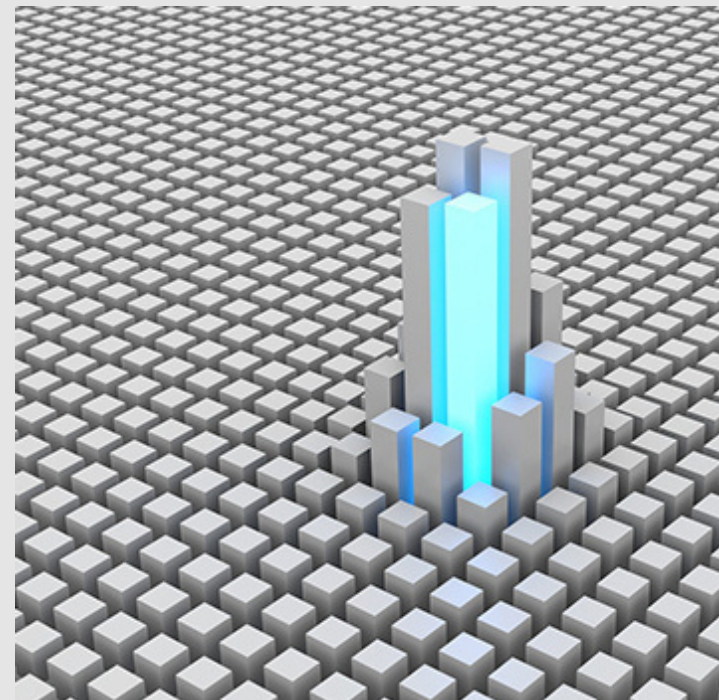

"Our role is to maximize value for our clients," explains lead QS Edwin Kengara. "We bring clarity and control to what is traditionally a complex process, ensuring every cent counts for both the employer and the contractor." Post-construction, TCCL's commitment extends far beyond handover. Predictive maintenance reporting and a 95% success rate in dispute resolution through arbitration exemplify the firm's dedication to long-term project success.

## Technology Meets Tradition

Innovation pulses through TCCL's operations. With tools like QS Plus—its proprietary cost estimation software—and DimensionX for 3D modeling, the firm reduces errors by 40% while providing clients with immersive pre-construction visualizations. Integration with Building Information Modeling (BIM) ensures seamless collaboration across multidisciplinary teams.

"Our tech stack isn't just about efficiency—it's about foresight," remarks Operations Manager Henry. The result is an agile, responsive consultancy equipped for the demands of modern construction.





Complementing this technological prowess is the human touch. TCCL’s team of over 15 professionals undergoes continuous training, ensuring they remain at the cutting edge of industry advancements such as green building certifications and sustainable construction techniques.

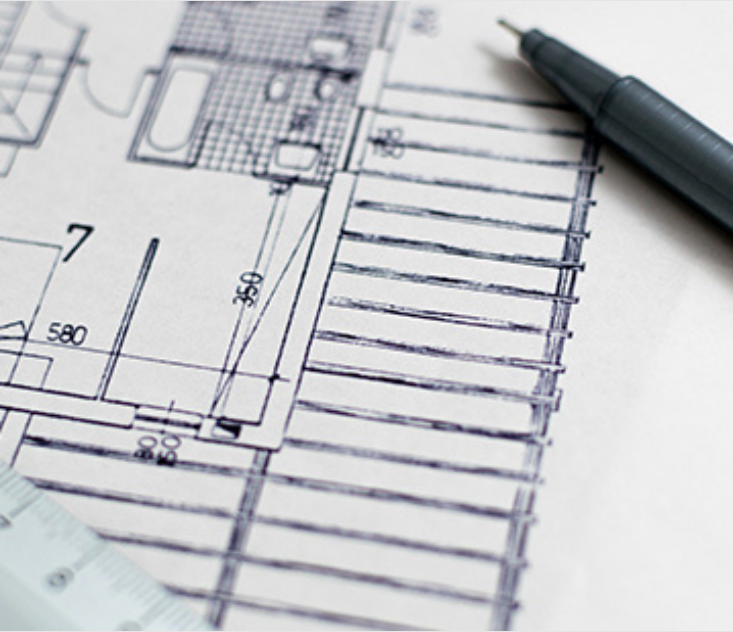

**Building the Icons of East Africa**

From luxury residences to commercial landmarks and hospitality gems, TCCL’s portfolio is a roadmap of East Africa’s rapid urbanization. Residential highlights include the expansive Phenom Estate, home to over 500 residences complete with a clubhouse and modern amenities, and the prestigious 88 Nairobi Condominium, offering penthouses and executive apartments with skyline views.



In the commercial and hospitality sectors, TCCL’s imprint is equally impressive. The Billionaire Resort & Retreat continues to draw global elites to Malindi, while the JW Marriott Masai Mara Lodge offers unparalleled luxury in the heart of the savannah. Meanwhile, projects like the Victoria at Two Rivers Office Block and the Park Medical Centre are redefining Nairobi’s commercial landscape. Some of our clientele include, but are not limited to, AMS Properties, Delta Properties, Nairobi Homes, Galleria Gardens, Yaya Towers, Sarova Group, and Lordship Africa.



Beyond cost management, TCCL has been advocating for digital transformation in construction through the use of Building Information Modeling (BIM), which enhances project planning, risk management, and collaboration among stakeholders. As Vision 2030 pushes for cities that are both technologically advanced and environmentally responsible, TCCL stands as a vital bridge between vision and practical, measurable outcomes. "Our goal is to build cities that breathe," declares CEO Joseph Kungu. "Sustainability isn’t a trend—it’s our duty." Expansion plans are equally ambitious. By 2026, TCCL aims to establish new offices in Ethiopia and Rwanda, further embedding itself in the region’s development narrative.

**Vision 2030: Towards Smart, Sustainable Cities**  
Looking ahead, TCCL is aligning its future with the continent’s aspirations for smart, sustainable urban centers. In the development of smart, sustainable cities under Vision 2030, TCCL is at the forefront of ensuring that projects are not only cost-effective but also aligned with environmental and technological goals. Traditionally responsible for managing construction costs and contracts, modern QSs are now deeply involved in lifecycle costing, sustainable procurement, and value engineering—making sure that sustainability measures such as green building materials, energy-efficient systems, and smart infrastructure are financially viable and efficiently integrated into urban projects. TCCL is committed to ensuring that investments in sustainability do not exceed budgets while still delivering long-term value.





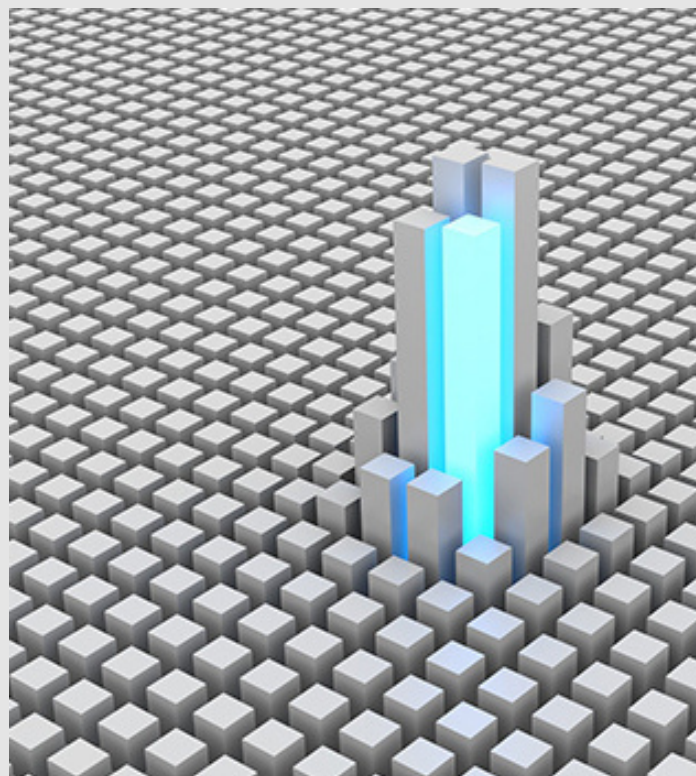

# Conclusion: Building Tomorrow, Today

As East Africa rises, so too does the need for partners who can turn visionary blueprints into reality. Tower Cost Consultants Limited is more than just a consultancy; it is a custodian of the region’s architectural dreams, crafting environments where communities flourish and economies thrive.

From boardrooms to construction sites, TCCL’s story is one of resilience, foresight, and unwavering excellence. And as they look to the future, one thing is certain: the skylines of tomorrow will bear the unmistakable mark of Tower Cost Consultants Limited.

## Contact Information

Website: [www.towercost.co.ke](http://www.towercost.co.ke)  
 Email: [info@towercost.co.ke](mailto:info@towercost.co.ke)  
 Phone: +254 786 869816



## URBAN MOBILITY



**Schindler**

WE ARE HAPPY TO BE ASSOCIATED WITH  
 TOWER COST CONSULTANTS LTD

Schindler Limited

Longonot Place, 1st Floor Kijabe Street  
 P.O Box 43410-00100, NAIROBI  
 Tel: 020 3340669/3312115/2226938/  
 0728 444 333/0733 615 353  
 Email: [info\\_nbo.ke@schindler.com](mailto:info_nbo.ke@schindler.com)  
[www.schindler.com](http://www.schindler.com)



**CANTON BUILDING & CONST. LTD.**  
**BUILDERS & GENERAL CONTRACTORS**

CANTON BUILDING & CONST. LTD. stands out for its commitment to innovation, quality, and timely delivery. Whether it's crafting bespoke construction solutions or providing cutting-edge structural engineering services, the company ensures every project is a testament to durability, functionality, and aesthetic appeal. Their team of skilled professionals, combined with state-of-the-art technology, guarantees seamless execution from concept to completion.

The Director, Mr. MANU KERAL, who is a Businessman with 18 years of progressive experience in Civil projects (Construction & Structural works) successfully steered the company with his clear vision and motivated strategies.

## STANDOUT ACHIEVEMENTS THAT REDEFINED SUCCESS



## OUR SERVICES: PRECISION IN EVERY PROJECT

Domestic:  
 Maisonettes houses, Studio Apartments, Individual Houses, Swimming pools, Gardens, Sauna's (steam bath & Hottubs), security walls & Fencing

Industrial:  
 Machinery Buildings/spaces, warehousing facilities, Industrial Roofing & Ceilings, Industrial Lightings and Electrifications, Office Buildings, Modern Office Setups and furniture works, Guest Houses, towers, swimming pools, Security walls, Plumbing for building .



WE ARE HAPPY TO BE ASSOCIATED WITH  
 TOWER COST CONSULTANTS LTD

LOCATION ICON BROTHER  
 KNIGHTWEAR GODOWN, LUNGA  
 LUNGA RD :  
 PHONE +254202430341  
 PHONE +254202430428  
 MOBILE +254722516296  
[HTTPS://EAMODERNBUILDER.COM/](https://EAMODERNBUILDER.COM/)



# The Beacon at Upper Hill



## A Visionary Landmark in Nairobi's Skyline

The Beacon stands as a testament to innovative design and urban transformation in Nairobi. Conceived by the late renowned British architect Will Alsop of a Design and developed in collaboration with Kiloran Development Group, this project is poised to redefine the retail and commercial landscape of Kenya's capital.

### Project Overview

Location: Strategically situated off Uhuru Highway, near the Bunyala Road roundabout, at the nexus of Nairobi's Central Business District, Industrial Area, and Upper Hill.

- Total Area: Approximately 28,500 square meters (306,771 square feet) encompassing retail, dining, and office spaces.
- Retail & Dining: 24,300 square meters dedicated to a diverse mix of retail outlets and food and beverage establishments.
- Office Space: A 4,200 square meter, seven-storey Grade A office tower offering panoramic views and modern amenities.
- Design Philosophy: An open-air mall concept emphasizing sustainability, family-friendly environments, and engaging architectural elements.

## Architectural Highlights



The Beacon's design is a reflection of Alsop's signature style—bold, playful, and unconventional:

- Monorail with "Jellybean" Carriages: An internal monorail system featuring vibrant, jellybean-shaped carriages, enhancing mobility and offering a unique visitor experience.
- Piano Staircase: A staircase designed to resemble piano keys, adding an interactive and musical element to the shopping experience.
- Fairground Attractions: Incorporation of elements like a helter-skelter and merry-go-round, infusing a sense of fun and nostalgia.
- Colorful Canopies: Walkways sheltered by vivid fabric canopies, providing shade and a festive atmosphere.
- Thatched Rooftop Restaurant: A rooftop dining area with a traditional thatched roof, blending modern design with cultural elements.
- Facade Design: A striking combination of monochromatic porcelain panels disrupted by a bold red "leisure box," creating a dynamic visual impact.



# Strategic Significance

- Positioned at a pivotal junction, The Beacon is set to become a central hub for commerce and leisure.
- Accessibility: Proximity to major roads and business districts ensures high footfall and easy access for shoppers and professionals alike.
- Economic Impact: Expected to stimulate the local economy through job creation, increased tourism, and enhanced retail opportunities.
- Urban Development: Contributes to Nairobi's vision of modern urban spaces that cater to the evolving needs of its residents and visitors.

# Sustainability and Innovation

The Beacon is not just about aesthetics; it's a forward-thinking project that embraces.

Environmental Responsibility: Open-air design reduces reliance on artificial climate control, promoting energy efficiency.

Community Engagement: Spaces designed to host events, performances, and community gatherings, fostering social cohesion.

Technological Integration: Incorporation of smart building technologies for enhanced security, navigation, and customer experience.

# Conclusion

The Beacon at Upper Hill is more than a shopping mall; it's a symbol of Nairobi's progressive spirit and a beacon of architectural excellence. By seamlessly blending functionality with artistic expression, it promises to offer an unparalleled experience to all who visit.





**We are proud to be the Structural Engineers for The Beacon at Upperhill project.**

Masfy Consultants has been trusted by governments, NGOs, corporations, and private investors to deliver:

- ✔ Structurally sound, future-ready buildings
- ✔ Innovative designs using Revit, SAP 2000, and BIM
- ✔ Sustainable, conservation-focused engineering
- ✔ Tailor-made solutions that bring client visions to life

**Why Choose US?**

- Experienced, fully qualified team
- Fully insured services
- High-quality drawings & calculations
- Smart, value-engineered designs
- Friendly, clear communication
- Fast, efficient turnaround
- Ongoing collaboration with your contractor & architect



**Build with the best. Contact Masfy Consultants today.**

t: +254 726 365 516 | [masfy.consultant@gmail.com](mailto:masfy.consultant@gmail.com)  
Visit us at The Oval, 2nd Floor

[www.masfyconsultants.com](http://www.masfyconsultants.com)





# REGINA CAELI CATHOLIC CHURCH



The Regina Caeli Catholic Church, located in the serene suburb of Karen along Lang'ata Road, stands as a beacon of faith and community spirit in Nairobi, Kenya. Established to serve the growing Catholic population in the area, the church has become a vital part of the local landscape since its inception. The parish was founded in response to the increasing number of families moving to Karen, a trend that has seen the area evolve into a vibrant community with diverse cultural backgrounds. The church's dedication on the Solemnity of the Immaculate Conception marked a significant milestone, symbolizing not only the completion of a physical structure but also the establishment of a spiritual home for many. This event was attended by parishioners, clergy, and community leaders, all of whom gathered to celebrate the church's mission of fostering faith, hope, and charity.

Architecturally, the Regina Caeli Catholic Church is a stunning representation of modern ecclesiastical design, harmoniously blending traditional Catholic elements with contemporary aesthetics. The church features a striking façade characterized by its high ceilings, large stained-glass windows, and a spacious nave that invites worshippers to gather in prayer and reflection. The use of natural light is a prominent feature, with the stained-glass windows depicting various biblical scenes that tell the story of salvation and the life of the Virgin Mary, after whom the church is named. The interior is designed to accommodate a growing congregation, with ample seating and a layout that encourages community interaction. The altar, a focal point of the church, is crafted from local materials, symbolizing the connection between the church and the Kenyan landscape. This thoughtful design not only enhances the worship experience but also serves as a reminder of the church's commitment to inclusivity and accessibility for all members of the community.

Beyond its architectural beauty, Regina Caeli Catholic Church plays a crucial role in the social fabric of the Karen community. The church is not merely a place of worship; it is a hub for various community activities and outreach programs. Regular events such as youth gatherings, Bible study sessions, and family retreats foster a sense of belonging among parishioners. The church also actively engages in charitable initiatives, providing support to the less fortunate through food drives, educational programs, and health clinics. These outreach efforts are vital in addressing the needs of the community, particularly in a region where socio-economic disparities exist. The church's commitment to social justice and service reflects the teachings of Christ and reinforces the importance of compassion and solidarity among its members.

Looking to the future, Regina Caeli Catholic Church has ambitious plans to expand its services and outreach initiatives. As the population in Karen continues to grow, the church recognizes the need to adapt and respond to the evolving needs of its congregation. Future projects may include the development of additional facilities, such as a community center that can host various activities, workshops, and events aimed at fostering community engagement. There is also a vision to enhance educational programs for both children and adults, focusing on spiritual formation and personal development. By investing in these initiatives, the church aims to strengthen its role as a pillar of support and guidance for families and individuals in the community.







The Regina Caeli Catholic Church stands as a testament to the power of faith and community. Its establishment has not only provided a place for worship but has also fostered a spirit of unity and service among the residents of Karen. As the church continues to grow and evolve, it remains committed to its mission of spreading the Gospel and serving those in need. The church invites all members of the community to participate in its activities and initiatives, emphasizing that the strength of the parish lies in the active involvement of its congregation. Through collective efforts, Regina Caeli Catholic Church will undoubtedly continue to be a source of inspiration, hope, and love for many generations to come.



## Community Impact and Engagement

The Regina Caeli Catholic Church has established itself as a cornerstone of the Karen community, not only through its spiritual offerings but also via its active engagement in various social initiatives. The church recognizes that faith is not solely about personal salvation but also about collective responsibility towards one another. This understanding has led to the implementation of numerous outreach programs aimed at addressing the diverse needs of the community. One of the most notable initiatives is the church's food bank, which operates on a monthly basis, providing essential supplies to families facing food insecurity. This program has been particularly impactful during challenging economic times, ensuring that no family goes hungry. Volunteers from the parish, including youth groups and adult parishioners, come together to collect, package and distribute food items, fostering a sense of camaraderie and shared purpose. In addition to the food bank, Regina Caeli Catholic Church has initiated educational programs that cater to both children and adults. The church runs a Sunday school program that not only teaches children about the Catholic faith but also emphasizes moral values, community service, and leadership skills. This program has been instrumental in nurturing the next generation of leaders within the church and the broader community. For adults, the church offers workshops and seminars on various topics, including financial literacy, mental health awareness, and parenting skills. These educational initiatives are designed to empower individuals with the knowledge and skills necessary to navigate life's challenges, thereby enhancing the overall well-being of the community.

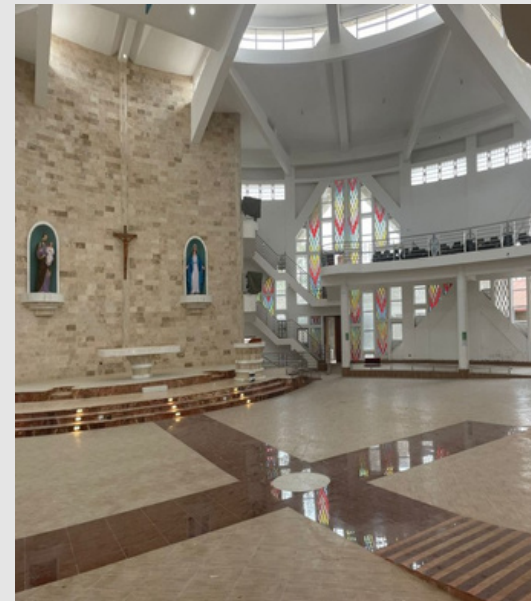

The church also places a strong emphasis on youth engagement, recognizing that young people are the future of the parish. Regular youth meetings, retreats, and social events provide a platform for young parishioners to connect, share their faith, and develop leadership skills. The youth ministry is not only about spiritual growth but also about fostering friendships and creating a supportive environment where young people can thrive. The church encourages its youth to take an active role in community service, organizing events such as clean-up drives, tree planting, and visits to local orphanages. These activities instill a sense of responsibility and compassion, reinforcing the church's mission to serve others.

## Environmental Stewardship

In recent years, Regina Caeli Catholic Church has also embraced the call for environmental stewardship, recognizing the importance of caring for God's creation. The church has initiated several eco-friendly projects aimed at promoting sustainability within the community. One such initiative is the establishment of a community garden on church grounds, where parishioners can grow fruits and vegetables. This garden not only provides fresh produce for the food bank but also serves as an educational tool for teaching sustainable farming practices. Workshops on composting, recycling, and water conservation are regularly held, encouraging parishioners to adopt environmentally friendly habits in their daily lives.







The church invites all members of the Karen community, regardless of their background, to participate in its various programs and initiatives. Whether through volunteering, attending services, or simply engaging in community events, every individual has a role to play in the life of the parish. In conclusion, the Regina Caeli Catholic Church is more than just a place of worship; it is a vibrant community hub that embodies the values of faith, service, and compassion. As it looks to the future, the church remains committed to its mission of spreading love and hope, ensuring that it continues to be a source of inspiration for all. The journey of faith is one that is best traveled together, and Regina Caeli Catholic Church stands ready to welcome all who seek to walk this path. Through collective efforts, the church will undoubtedly continue to make a lasting impact on the lives of its parishioners and the broader community for years to come.

The church has also taken steps to reduce its carbon footprint by implementing energy-efficient practices within its facilities. Solar panels have been installed to harness renewable energy, and efforts are being made to minimize waste through recycling programs. By leading by example, Regina Caeli Catholic Church aims to inspire the community to take action in protecting the environment, aligning with the broader Catholic teaching on the care of creation. Conclusion and Call to Action As Regina Caeli Catholic Church continues to grow and evolve, it remains steadfast in its commitment to serving the Karen community. The church's multifaceted approach encompassing spiritual growth, social outreach, education, and environmental stewardship demonstrates its dedication to fostering a holistic sense of community.







**As a premier Mechanical, Electrical, and Plumbing (MEP) consultancy in Kenya, we offer comprehensive engineering services tailored for building and civil engineering developers. Trust Gedox Associates to elevate your projects with expertise and innovation.**

### OUR SERVICES

Medium & Low Voltage Engineering Services  
Extra Low Voltage Engineering Services  
Security Systems  
Fire Safety and Security  
Lifts & Elevator Solutions

**WE ARE PROUD TO BE THE ELECTRICAL ENGINEERS FOR THE REGINA CAELI CATHOLIC CHURCH, KAREN ,LANGATA ROAD PROJECT**

 +2543750157 / 2636000/  
Mobile: +254725853753

 info@gedox.net /  
gedox01@gmail.com  
www.gedox.net

 MMID Studio, 2nd Floor Westlands Road,  
P.O. Box 64441 – 00620, Nairobi, Kenya



# Eighty Eight Nairobi: Redefining Urban Living in East Africa



In the bustling heart of Nairobi's Upper Hill district, a groundbreaking development is taking shape — Eighty Eight Nairobi. Poised to become the tallest residential structure in Sub-Saharan Africa upon completion, this ambitious project represents a major leap in Kenya's real estate sector and a significant step toward redefining urban living in the

region. The Eighty Eight Nairobi project, often stylized as 88 Nairobi, is the brainchild of Lordship Africa, a prominent real estate development firm with a track record of delivering luxury properties across East Africa and Europe. Envisioned as a mixed-use luxury skyscraper, the building is designed to offer a blend of

residential apartments, high-end retail spaces, office areas, and leisure facilities, all within a single, vertical community. It is set to soar to a height of approximately 176 meters, comprising 44 floors of sleek, modern design. The Vision Behind Eighty Eight Nairobi Upper Hill, historically a low-rise commercial hub, has transformed over the past decade into one of Nairobi's most sought-after business addresses. With the influx of multinational corporations, banks, and embassies, demand for high-end housing in the vicinity has skyrocketed. Eighty Eight Nairobi seeks to meet this demand by providing luxurious living spaces tailored to the lifestyles of executives, expatriates, and high-net-worth individuals who want to live close to where they work. Speaking about the project, Jonathan Jackson, Founder of Lordship Africa, emphasized that Eighty Eight Nairobi is not just about height, but about setting a new standard for quality and convenience in urban living. The concept behind the tower reflects global trends seen in major cities like New York, London, and Dubai, where vertical living offers residents access to a range of amenities without ever needing to leave the building.



## Design and Architecture

Eighty Eight Nairobi is a striking architectural statement. Its design incorporates contemporary aesthetics with functionality and sustainability in mind. The façade features sleek lines and glass, creating an elegant, futuristic look that stands out against Nairobi's skyline.

Inside, the tower will house a range of apartment types, from studios to lavish three-

bedroom units and penthouses, each

designed with open-plan layouts, floor-to-ceiling windows, and premium finishes. Smart home features will be integrated, offering residents control over lighting, security, and climate through their smartphones.

Amenities in the building are comparable to those found in five-star hotels. These include a heated infinity pool, a wellness and fitness center, private gardens, restaurants, a business lounge, a concierge service, and even a helipad for ease transportation. The building's emphasis on security —

including biometric access controls and 24/7 surveillance — ensures that residents can enjoy peace of mind.

## Sustainability at the Forefront

One of the key aspects of Eighty Eight Nairobi is its commitment to sustainability. The tower incorporates energy-efficient systems, rainwater harvesting, and waste management protocols designed to minimize its environmental footprint. In an era when cities across Africa are grappling with rapid urbanization and environmental challenges, such measures are both timely and necessary.

Green spaces have been thoughtfully integrated into the project, with landscaped gardens and sky decks providing much-needed oases within the vertical structure.







## Economic and Social Impact

The development of Eighty Eight Nairobi has already had a ripple effect on the local economy. The construction phase has generated employment for hundreds of workers, while the completed project is expected to create permanent jobs in property management, retail, and hospitality services. Moreover, the success of Eighty Eight Nairobi could act as a catalyst for further high-rise developments in Nairobi, encouraging a shift toward vertical urbanization. This approach could offer a sustainable solution to Nairobi's persistent challenges with traffic congestion, land scarcity, and

housing shortages. From a social standpoint, the project is also helping to position Nairobi as a city of the future — a cosmopolitan hub that can compete with major urban centers globally. It sends a strong signal to investors and developers that Nairobi is open for innovation, luxury development, and new forms of urban living.

## Conclusion

Eighty Eight Nairobi is more than just a skyscraper; it is a symbol of ambition, growth, and modernization. By blending luxury, convenience, and sustainability, the project is setting new benchmarks for residential living in Nairobi and beyond.

As Africa's urban landscapes continue to evolve, developments like Eighty Eight Nairobi offer a glimpse into the future — one where cities are designed not only to be larger, but smarter, greener, and more livable. With completion nearing, the excitement surrounding Eighty Eight Nairobi continues to grow. For Nairobi residents and investors alike, the tower represents a bold step toward a dynamic, world-class urban lifestyle in the heart of East Africa.

# WHITE STEID CONSTRUCTION LTD

We are honored and proud to serve as the main contractor for the Eighty Eight Nairobi project. This landmark development represents innovation, excellence, and progress in Kenya's dynamic construction landscape. Being entrusted with such a prestigious project reflects our commitment to quality, expertise, and delivering world-class infrastructure. We look forward to contributing to Nairobi's skyline and setting new standards in construction

**WE ARE PROUD TO BE THE MAIN CONTRACTOR FOR  
EIGHTY EIGHT , NAIROBI PROJECT**

**eighty eight**  
NAIROBI'S ICON

Tel ; white steid  
construction ltd:  
0724 969 802

Precision in every beam, pride in every brick, delivering excellence that stands the test of time



# Westlands Road Apartments – Nairobi

## Project Overview

The Westlands Road Apartments project represents a flagship residential development in one of Nairobi's most prominent commercial and residential hubs—Westlands. This project directly responds to the increasing demand for upscale, secure, and functional residential spaces in the urban core. Strategically situated along Westlands Road, the development provides future residents with unmatched accessibility to Nairobi's major commercial centers, educational institutions, entertainment facilities, and transport links. Designed to cater to professionals, families, and investors seeking modern amenities and a premium lifestyle, Westlands Road Apartments offers a perfect blend of comfort, architectural appeal, and structural integrity. El Arca Limited was commissioned to provide comprehensive engineering services, including structural and civil engineering design as well

as construction supervision. Our interdisciplinary team played a vital role throughout the project lifecycle, from concept design to project handover. The design philosophy and approach of the project were envisioned as a high-rise residential complex featuring multiple apartment units, basement parking, and recreational amenities. Our team adopted a holistic and collaborative approach, ensuring seamless coordination between architects, developers, and contractors. The structural framework consists of a reinforced concrete system optimized for high-rise construction. The design was developed to balance safety, functionality, and aesthetic quality while meeting the client's expectations for cost-efficiency and long-term durability.

From the outset, our goal was to deliver an engineering solution that not only upheld structural soundness but also complemented the architectural intent. It means careful attention to load distribution, column placement, and material optimization. In addition to the core structure, we designed integrated civil works such as stormwater drainage, internal roadworks, and water supply systems. These components were engineered to align with Nairobi's urban infrastructure standards and to support sustainable urban living.

## Challenges and Solutions

Urban developments in Nairobi, particularly in high-traffic zones like Westlands, often come with unique logistical and technical challenges. In this project, our team had to manage constraints such as limited site access, high pedestrian and vehicular traffic, and



adherence to tight construction schedules. To address these challenges, we adopted a phased construction strategy that prioritized site safety and resource efficiency. Advanced planning software and BIM coordination tools were used to model structural elements and services, enabling real-time clash detection and smoother construction execution. Environmental sustainability was another key consideration. Our engineering approach minimized material wastage and incorporated environmentally friendly construction practices where possible. Rainwater harvesting and energy-efficient plumbing designs were included to enhance long-term sustainability. Project Highlights

- **Basement Parking:** Designed to maximize space efficiency while maintaining structural stability and ventilation standards.
- **Reinforced Concrete Frame:** Engineered to withstand both vertical and lateral loads, ensuring safety and compliance with Kenya's building codes.
- **Civil Works Integration:** Incorporation of smart drainage systems and optimized site grading for storm water management.
- **Structural Efficiency:** Value-engineered to balance material use and cost with performance and longevity.
- **Construction Supervision:** Full-time site supervision by El Arca Limited's team ensured adherence to quality standards, timelines, and regulatory compliance.



Impact and Legacy Westlands Road Apartments has significantly contributed to the evolving landscape of Nairobi's urban housing market. It stands as a testament to thoughtful engineering and collaborative development. The project has not only enhanced the architectural fabric of the area but also created a model for future residential developments. By working closely with stakeholders and applying our integrated engineering and management approach, El Arca Limited delivered a project that exemplifies modern urban design, structural resilience, and quality craftsmanship. As Nairobi continues to grow, projects like Westlands Road Apartments demonstrate the vital role of multidisciplinary engineering in shaping sustainable and liveable cities.



- INTEGRITY
- COLLABORATION
- CUSTOMER FOCUS
- QUALITY



*We are happy to be associated with Hai Jiang International Co. Ltd's Westlands Road developments*

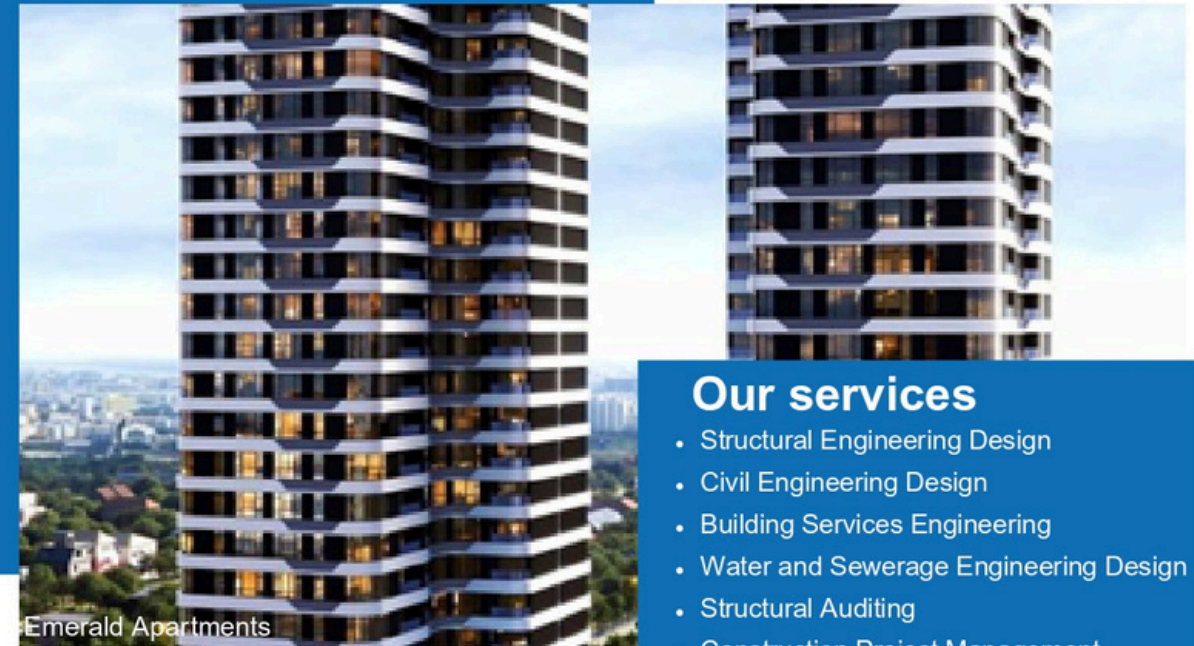

Emerald Apartments

### Our services

- Structural Engineering Design
- Civil Engineering Design
- Building Services Engineering
- Water and Sewerage Engineering Design
- Structural Auditing
- Construction Project Management
- Roads and Transportation Engineering

### Who are we?

El Arca Limited, founded in 2012, is a multidisciplinary engineering design firm committed to delivering tailored solutions for property developers and individual clients. Since our inception, we have specialized in providing a wide range of services in civil, structural, an infrastructure design, along with comprehensive project supervision.

We approach every project with a broad, interdisciplinary outlook, blending specialized expertise and hands-on experience. Our integrated engineering and management services are built on a solid foundation of knowledge and resources, enabling us to effectively meet the unique needs of each client.

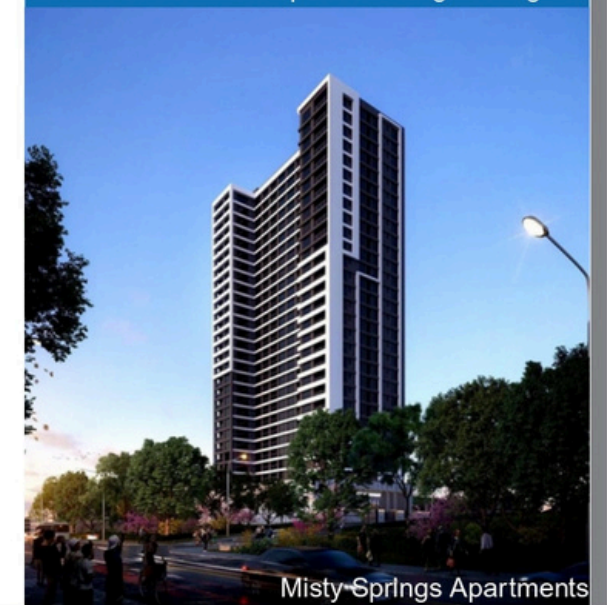

Misty Springs Apartments

Marsabit Plaza,  
off Ngong Road  
Suite 208, Second Floor  
PO BOX 2941 – 00621,  
Nairobi, Kenya

+254 733 226 840  
+254 736 353 983  
info@el-arca.co.ke  
www.el-arca.co.ke



# AFRICA CENTRAL AREA OFFICE PROJECT (ACAO)



## A Foundation of Faith and Growth

A significant new construction is underway in Nairobi's Lang'ata district, next to the familiar Galleria Office Park — the Africa Central Area Office for The Church of Jesus Christ of Latter-day Saints. This landmark project, which broke ground in March 2024, will serve as the spiritual and administrative heart of the Church in East and Central Africa. The ceremony gathered Church leaders, dignitaries, and local Saints to witness the official start of a long-anticipated vision. “This building will strengthen our ability to bless lives,” said Elder S. Mark Palmer, President of the Africa Central Area Presidency. “It is both a gift and a responsibility.”

## Why Nairobi? Why Now?

Nairobi serves as a logistical and spiritual gateway to the region. With more than 800,000 members across 18 countries, the Africa Central Area of the Church required a permanent, centralized facility. The new office, located next to the Church's previously leased Galleria Office Park space, is a critical step forward. This purpose-built complex includes:

- Multi-story office facilities
- Conference and training spaces
- Staff support and resource coordination hubs
- Sustainability features such as solar energy and water harvesting systems

The building's modern, functional architecture has been entrusted to a team of experienced professionals:



## A Tool for Ministry

The new area office will coordinate key operations across the continent: missionary work, education, humanitarian aid, family history, and welfare programs. With specialized departments under one roof, Church leaders and employees will better support local stakes and branches. “This office enables us to serve more effectively,” said Elder Ian S. Ardern, former Africa Central Area President. “It allows us to meet the needs of the Saints while also partnering with communities.”

The proximity of the office to the Nairobi Kenya Temple, currently under construction in Mountain View, underscores Nairobi's growing importance as a Church center.

## Community and Member Impact

For local members, the project is more than an office — it's a reflection of their faith and contribution to the growth of the Church. “When I see this building go up, I think of how far we've come,” said Sister Miriam Wanjiku of the Nairobi West Stake. “It's not just Church headquarters. It's a symbol that the Lord remembers us here.”

Beyond spiritual benefits, the Church's decision to use local consultants, labor, and subcontractors brings economic opportunity and skill development to the community. The construction process is creating jobs and establishing new standards for sustainability and excellence, reinforcing the Church's principle of self-reliance and community upliftment.



### Building for the Future

The project is scheduled for completion in late 2025 or early 2026. Upon completion, it will operate as a regional command center, shaping everything from humanitarian outreach to leadership training, while anchoring the Church's expanding African footprint.

“This is a historic moment,” said one Church official. “Africa is not just part of the Church’s future — it is leading it.”

From the temple to the new area office, Nairobi is becoming a spiritual and administrative hub. As the steel rises and walls take form, one thing is certain: this is more than a building — it’s a foundation for generations.

### Project Summary

- Project: Africa Central Area Office
- Location: Next to Galleria Office Park, Lang’ata, Nairobi
- Client: The Church of Jesus Christ of Latter-day Saints
- Architects: Symbion Kenya Ltd.
- Main Contractor: Ark Construction Ltd.
- Quantity Surveyors: GETSO Consultants Ltd.
- Structural Engineers: Metrix Integrity Consultancy Ltd.
- Electrical Subcontractors: Master Power Systems Ltd.
- Plumbing & Drainage Subcontractors: Jaisham Ltd.
- Construction Start: March 2024
- Expected Completion: Late 2025 – Early 2026





# ARK CONSTRUCTION LIMITED

**BUILDING WITH INTEGRITY, EXCELLENCE AND PURPOSE**

## OUR AREA OF SPECIALIZATION

- Building Construction and Associated Civil Works
- Office and Shop Fit Outs
- Aluminum and Glazing Works
- Metal, Timber and Joinery Fabrication Works
- General Renovation Works



### WE ARE PROUD TO BE ASSOCIATED WITH THE CHURCH OF JESUS CHRIST NRB CENTRAL AREA OFF LANGATA ROAD

3rd Floor, The Address Building  
Along Muthangari Drive ,Off Waiyaki Way  
P.O. Box 21073 – 00100 NRB, Kenya

Email: [info@arkconstruction.co.ke](mailto:info@arkconstruction.co.ke)  
Website: [www.arkconstruction.co.ke](http://www.arkconstruction.co.ke)  
(Office): +254 721 720 975  
+254 734 720 975





**HARVEY TileEco<sup>®</sup>**  
A DIVISION OF MACSTEEL

# The green roof tile

Welcome to the future of roofing – a technological breakthrough from Harvey Roofing Products: the Harvey EcoTile<sup>®</sup>.

Harvey EcoTile<sup>®</sup> is a mineral composite roof tile. By utilising 98% waste material, Harvey EcoTile<sup>®</sup> is 100% recyclable yet provides superior functional benefits to other roofing options.

Harvey EcoTile's<sup>®</sup> technological design advantage ensures an interlocking, lightweight tile that is low on maintenance, weatherproof and virtually unbreakable in normal use.

Your building's roof is one of its most important elements in function, aesthetics, surface area and investment. Increase its functional performance and green credentials with one innovative product – Harvey EcoTile<sup>®</sup>.



- |             |                 |                |                 |            |                    |
|-------------|-----------------|----------------|-----------------|------------|--------------------|
|             |                 |                |                 |            |                    |
| Lightweight | Low Maintenance | Durable        | Weatherproof    | Attractive | Easy to Install    |
|             |                 |                |                 |            |                    |
| Paintable   | SANS 10400-T    | Waste Material | 100% Recyclable | Waterless  | Community Projects |

**Harvey Roofing Products**  
A DIVISION OF MACSTEEL  
Tel: +27 11 741 5600    www.harveyroofingproducts.co.za

# Safeguarding the Future: How Flammatech is Redefining Fire Safety Standards

## DESIGN . BUILD . MAINTAIN



**Engineering Fire Safety in East Africa**  
In a world where safety and business continuity are critical, fire protection is no longer just a regulatory checkbox — it's a vital part of operational resilience. At the forefront of this essential mission stands Flammatech, a leader in innovative fire safety solutions, committed to safeguarding lives, assets, and futures.

**A Vision Born from Expertise**  
Driven by a passion for engineering excellence and safety innovation, Flammatech has rapidly established itself as a trusted partner across industries — from manufacturing and oil & gas

to healthcare, commercial spaces, and data centers. Their approach is rooted in deep technical expertise, regulatory compliance, and a relentless pursuit of excellence. They strongly believe that fire safety is not a product—"it's a commitment." From humble beginnings to becoming a regional powerhouse, Flammatech Limited has emerged as a leader in the fire safety and protection industry. Their client base spans major corporations, financial institutions, and government bodies, all drawn by Flammatech's dedication to quality, compliance, and innovation.



Founded to address the critical need for comprehensive fire safety systems across East Africa, the company initially focused on portable firefighting equipment. However, its rebranding from Firetec International Limited to Flammatech in 2011 marked a strategic pivot toward full-spectrum fire safety services. The transition signified their commitment to regional leadership and a brand identity grounded in technology and customer-centric service.

The founders, driven by a vision for safer communities and resilient urban infrastructure, have invested in continuous staff training, research, and international certifications. Over the years, Flammatech has built strong partnerships with global manufacturers and tech providers, enabling them to supply certified, high-quality fire safety products tailored for African environments.

Flammatech's expansion into Rwanda and other East African regions is a testament to its growing influence. Today, they are more than just a vendor — they are strategic consultants for developers, government bodies, schools, and institutions seeking fire code integration, risk analysis, and sustainable safety planning.



**Meeting Every Fire Safety Need: Flammatech's Portfolio**

Flammatech offers a comprehensive range of world-class fire safety products and services, designed to meet the evolving needs of modern industries:

- **Fire Extinguishers:** Including ABC dry powder, CO<sub>2</sub>, foam, and water-type extinguishers for various fire risks.
- **Fire Detection Systems:** Intelligent addressable fire alarm systems, advanced smoke and heat detectors.
- **Fire Suppression Systems:** FM200, Novec 1230, and inert gas suppression systems for sensitive areas like server rooms.
- **Hydrant and Sprinkler Systems:** Turnkey design, installation, and maintenance services.
- **Fire Pumps and Controllers:** High-performance systems for reliable water supply.
- **Fire Doors and Shutters:** Certified, aesthetically aligned fire-rated doors and rolling shutters.
- **Emergency Lighting and Signage:** Compliant evacuation signage and backup lighting systems.

Flammatech also operates the only certified gas suppression system refilling station in the East African region, ensuring complete lifecycle support.

Every product is engineered for peak performance and tested to meet both national and international safety standards. Their in-house design team ensures each system is tailored to the client's risk landscape. As Kirtan Patel, director, states, "Solutions are not one-size-fits-all. Every project is tailored, ensuring maximum protection aligned with each client's specific risk landscape."

Flammatech offers a comprehensive range of world-class fire safety products and services, designed to meet the evolving needs of modern industries:

**Fire Extinguishers:** Including ABC dry powder, CO<sub>2</sub>, foam, and water-type extinguishers for various fire risks.

**Fire Detection Systems:** Intelligent addressable fire alarm systems, advanced smoke and heat detectors.

**Fire Suppression Systems:** FM200, Novec 1230, and inert gas suppression systems for sensitive areas like server rooms.

**Hydrant and Sprinkler Systems:** Turnkey design, installation, and maintenance services.

**Fire Pumps and Controllers:** High-performance systems for reliable water supply.

**Fire Doors and Shutters:** Certified, aesthetically aligned fire-rated doors and rolling shutters.

**Emergency Lighting and Signage:** Compliant evacuation signage and backup lighting systems.

Flammatech also operates the only certified gas suppression system refilling station in the East African region, ensuring complete lifecycle support.

Every product is engineered for peak performance and tested to meet both national and international safety standards. Their in-house design team ensures each system is tailored to the client's risk landscape. As Kirtan Patel, director, states, "Solutions are not one-size-fits-all. Every project is tailored, ensuring maximum protection aligned with each client's specific risk landscape."

**Services: Beyond Installation**

Flammatech doesn't just deliver hardware — they deliver peace of mind. Their end-to-end services include:

- Site audits and risk assessments
- System design and installation
- Scheduled maintenance
- Fire safety and evacuation training

Their training programs, certified by the Government of Kenya, are trusted by corporates, institutions, and NGOs seeking to empower staff with real-world emergency response skills.

**Major Projects and Impactful Installations**

Flammatech's footprint speaks volumes. Projects include:

- Carrefour Ruiru
- The Atrium
- Gem Forest Hotel
- Kengen Olkaria

These projects showcase their ability to execute scalable, reliable systems — from kitchen suppression to data center protection.

**Trusted by the Best: Clientele and Testimonials**

Flammatech is trusted by global and regional giants like:

- Microsoft
- Safaricom
- Knight Frank
- Guardian Bank
- Sarit Centre

Their technical expertise, adaptability, and capacity to deploy across remote counties make them a preferred partner for large-scale infrastructure and real estate projects.

**Training and Community Engagement**

Flammatech believes in a culture of preparedness. Their Firesafe Seminars bring together engineers, safety officers, and the public to raise awareness and share best practices. Community training initiatives include fire drills, emergency planning, and evacuation simulations.



### Certifications, Compliance, and Industry Leadership

A certified member of the Fire Protection Association of Kenya (FIPAK), Flammatech adheres to DOHSS regulations, ISO, and NFPA standards. Their focus on compliance positions them as thought leaders in national fire safety policy discussions.

### Outlook: Expansion and Innovation

With active operations in Rwanda and expansion plans across East Africa, Flammatech is scaling fast. Their innovation roadmap includes:

- Smart fire detection systems
- AI-based surveillance
- IoT-driven integrations
- Ongoing investment in talent and training

As Director Kirtan Patel affirms:

“At Flammatech, we focus on delivering practical, reliable solutions that stand the test of time. Our approach is simple: put safety first, stay innovative, and always prioritize the needs of our clients.”



### Closing

The future of fire safety is intelligent, integrated, and sustainable — and Flammatech is leading the charge. As risks become more complex and industries more dynamic, the company remains committed to innovating faster, training smarter, and protecting better.

If your organization is ready to move beyond compliance and truly safeguard its future, Flammatech is ready to partner with you.



Contact Flammatech: Website: <https://flammatech.africa>

Phone: +254 730 792 999

# Industrial robotic solutions

## LAND • AIR • WATER



### WHY ACCESSIONAL?

- UTILISES STATE OF THE ART TECHNOLOGY
- ELIMINATES DANGER AND SAVES COSTS
- IMPORTS MACHINES FROM LEADING GLOBAL BRANDS
- CUSTOM, LOCALLY PRODUCED ROBOTIC EQUIPMENT AND SOFTWARE
- SERVICES MULTIPLE INDUSTRY SECTORS
- CUSTOM SOFTWARE DEVELOPED IN-HOUSE AND TAILORED TO CLIENT'S NEEDS, ENSURING JOB SPECIFIC DATA VISUALISATION AND REPORTING
- VIRTUAL REALITY SIMULATIONS ALSO AVAILABLE

**ACCESSIONAL** specialises in robotic solutions for confined and dangerous spaces and, in doing so, offer our clients the ability to remove employees from dangerous situations – placing them in safe and remote locations whilst performing high-risk tasks. As the official African agents for **Inuktun** and **Seamor Marine**, we offer products from some of the leaders in the field of robotics. We also run our own in-house engineering department with qualified roboticists, developing tailor-made robotic solutions to suit any client's needs.

## ACCESSIONAL

CONFINED AND DANGEROUS SPACE SPECIALISTS

PLEASE CONTACT US TODAY FOR MORE INFORMATION

+27 [0]10 900 4073

[www.accessential.co.za](http://www.accessential.co.za)

[www.ryonicrobotics.com](http://www.ryonicrobotics.com)





Safety Standards: Importance of Safety Regulations in Construction

The construction industry is inherently hazardous, with workers exposed to various risks, including falls, equipment accidents, and exposure to harmful materials. As such, the implementation of safety standards and regulations is crucial for protecting the health and well-being of workers, minimizing accidents, and ensuring the successful completion of projects. This analysis explores the importance of safety regulations in construction, examining their impact on worker safety, project efficiency, legal compliance, and overall industry reputation.

**1. Protecting Worker Health and Safety.** The primary purpose of safety regulations in construction is to protect the health and safety of workers. According to the International Labour Organization (ILO), construction is one of the most dangerous industries globally, accounting for a significant percentage of workplace fatalities and injuries. Safety regulations establish guidelines and protocols that help mitigate risks and create safer working environments. For instance, regulations often mandate the use of personal protective equipment (PPE), such as helmets, gloves, and safety harnesses to minimize the risk of injury. Additionally, safety training programs are required to educate workers about potential hazards and safe work practices. By ensuring that workers are equipped with the necessary knowledge and tools, safety regulations significantly reduce the likelihood of accidents and injuries on construction sites. Moreover, the implementation of safety standards fosters a culture of safety within organizations. When companies prioritize safety and adhere to regulations, it sends a clear message to employees that their well-being is valued. This culture not only enhances morale but also encourages workers to take personal responsibility for their safety and that of their colleagues.

**2. Enhancing Project Efficiency** Safety regulations also play a critical role in enhancing project efficiency. When safety measures are in place, the likelihood of accidents and disruptions decreases, allowing projects to proceed on schedule. Accidents can lead to significant delays, as investigations must be conducted, and injured workers may require time off for recovery. These delays can result in increased costs and project overruns, ultimately affecting the bottom line. Furthermore, a safe working environment contributes to higher productivity levels. Workers who feel safe and secure are more likely to focus on their tasks and perform at their best. Conversely, when safety is compromised, workers may become anxious or distracted, leading to decreased efficiency and potential mistakes. By adhering to safety regulations, construction companies can create an environment that promotes productivity and ensures that projects are completed on time and within budget.

**3. Legal Compliance and Liability** Compliance with safety regulations is not only a moral obligation but also a legal requirement. Governments and regulatory bodies establish safety standards to protect workers and the public, and failure to comply can result in severe consequences. Construction companies that neglect safety regulations may face legal penalties, including fines, work stoppages, and even criminal charges in cases of gross negligence. Moreover, non-compliance can lead to increased liability for construction firms. In the event of an accident, companies may be held responsible for injuries or damages resulting from unsafe practices. This liability can result in costly lawsuits, insurance claims, and reputational damage. By adhering to safety regulations, construction companies can mitigate these risks and protect themselves from potential legal repercussions.

**4. Improving Industry Reputation** The construction industry has historically faced scrutiny regarding safety practices, and incidents of accidents and fatalities can tarnish the reputation of companies and the industry as a whole. By prioritizing safety and adhering to regulations, construction firms can enhance their reputation and build trust with clients, stakeholders, and the public. A strong safety record can be a significant competitive advantage in the construction industry. Clients are increasingly seeking contractors with proven safety performance, as it reflects a commitment to quality and professionalism. Companies that demonstrate a dedication to safety are more likely to secure contracts and maintain long-term relationships with clients. Additionally, a positive safety culture can attract top talent to the industry. Skilled workers are more likely to choose employers that prioritize their safety and well-being. By fostering a reputation for safety, construction companies can enhance their ability to recruit and retain skilled labor, which is essential for maintaining competitiveness in a rapidly evolving industry.

**5. Continuous Improvement and Adaptation.** The importance of safety regulations in construction extends beyond compliance; it also involves a commitment to continuous improvement and adaptation.

As the industry evolves, new technologies, materials, and practices emerge, presenting both opportunities and challenges for safety. Construction companies must stay informed about the latest safety standards and best practices to ensure that their operations remain safe and compliant. Regular safety audits and assessments are essential for identifying potential hazards and areas for improvement. By conducting thorough evaluations of construction sites and processes, companies can proactively address safety concerns and implement necessary changes. Additionally, fostering open communication and feedback among workers can help identify safety issues and promote a culture of continuous improvement. Training and education are also critical components of maintaining safety standards. Ongoing training programs ensure that workers are aware of the latest safety protocols and practices, empowering them to take an active role in their safety. By investing in training and development, construction companies can create a workforce that is knowledgeable, skilled, and committed to safety. In conclusion, safety regulations are of paramount importance





The future of the construction industry will be heavily influenced by technological advancements. Embracing innovative technologies such as artificial intelligence, IoT, and advanced project management software can enhance construction efficiency, reduce costs, and improve safety on construction sites. Companies that invest in technology will be better positioned to compete in a rapidly evolving market and meet the demands of modern infrastructure development.

Regional collaboration will be essential for addressing shared challenges and maximizing opportunities in the construction sector. Initiatives such as the East African Community (EAC) can facilitate cross-border projects that enhance infrastructure connectivity and promote economic integration. By working together, East African countries can leverage their collective resources and expertise to tackle common challenges and drive sustainable development.

**5. Promoting Sustainable Practices:** As the construction industry evolves, the promotion of Sustainable practices will be critical for ensuring long-term viability. Companies should prioritize environmentally friendly materials, energy-efficient designs, and waste reduction strategies In their projects. By aligning with global sustainability goals, the construction sector can attract investment from environmentally conscious investors and contribute to the region's overall development.

In summary, the construction industry in East Africa is poised for significant growth, driven by infrastructure development, public-private partnerships, and a commitment to sustainability. While challenges such as labor shortages and rising material costs persist, the future of the industry holds promise through strategic planning, innovation, and collaboration among stakeholders. By addressing these challenges

East Africa is undergoing a transformative phase characterized by rapid economic growth, urbanization, and increasing investment in infrastructure. As traditional markets mature, new opportunities are emerging across the region, driven by demographic shifts,

**Challenges:** Despite the opportunities, the real estate sector faces challenges, including regulatory hurdles, land acquisition issues, and rising construction costs. Navigating the complex regulatory environment can be time-consuming and may deter potential investors. Furthermore, the lack of access to financing for low-income households can hinder the growth of affordable housing projects. Addressing these challenges will be crucial for unlocking the full potential of the real estate market in East Africa.

Office Upper Hill Road,  
Upper Hill, Near Citi Bank  
Opposite Church of Jesus Christ Of Latter Day  
Saints, Mount Meru Court, Suite No. 4.



**Final Thoughts: Reflections on the Future of Construction in East Africa and the Role of Digital Tools in Project Management**

The construction industry in East Africa stands at a crossroads, characterized by rapid growth, increasing urbanization, and a pressing need for infrastructure development. As the region continues to evolve, the future of construction will be shaped by various factors, including technological advancements, changing market dynamics, and the need for sustainable practices. Among these factors, the role of digital tools in Project management will be pivotal in driving efficiency, enhancing collaboration, and improving project outcomes. This reflection explores the future of construction in East Africa, emphasizing the transformative impact of digital tools on project management practices.



**The Evolving Landscape of Construction in East Africa**

East Africa is experiencing unprecedented growth, with urban populations expanding rapidly and infrastructure demands escalating. According to the United Nations, the urban population in the region is projected to double by 2050, necessitating significant investments in housing, transportation, and public services. Governments are increasingly recognizing the importance of infrastructure development as a catalyst for economic growth and social progress. Initiatives such as Kenya's Vision 2030 and Uganda's National Development Plan highlight the commitment to enhancing infrastructure to support sustainable development.



**2. The TransformativTools**

Digital tools are revolutionizing project management in the construction sector, offering a range of benefits that enhance efficiency, collaboration, and decision-making. The adoption of technologies such as Building Information Modeling (BIM), project management software, and mobile applications is transforming how construction projects are planned, executed, and monitored.

**Enhanced Collaboration and Communication:** One of the most significant advantages of digital tools is their ability to facilitate collaboration among project stakeholders. In a sector where multiple parties are involved—architects, engineers, contractors, and clients—effective communication is essential for project success. Digital platforms enable real-time information sharing, ensuring that all stakeholders are aligned and informed throughout the project lifecycle. This enhanced collaboration reduces misunderstandings, minimizes delays, and fos-

e Impact of Digital **Data-Driven Decision Making:** The construction industry generates vast amounts of data, and digital tools enable project managers to harness this data for informed decision-making. By utilizing data analytics, construction firms can identify trends, assess risks, and optimize resource allocation. For example, predictive analytics can help project managers anticipate potential challenges, allowing them to take proactive measures to mitigate risks. This data-driven approach enhances project outcomes and contributes to overall efficiency.

**Increased Efficiency and Productivity:** Digital tools streamline project management processes, reducing the time and effort required for tasks such as scheduling, budgeting, and reporting. Automation of routine tasks allows project managers to focus on higher-value activities, such as strategic planning and stakeholder engagement. The use of project management software can significantly improve productivity by providing a centralized platform for tracking progress, managing budgets, and coordinating resources. As a result, construction firms can complete projects more efficiently and effectively.



**The Future of Construction: Embracing Digital Transformation**

As East Africa's construction industry continues to evolve, the future will be characterized by an increasing reliance on digital tools and technologies. Several key trends are likely to shape the landscape of construction in the region:

**1. Integration of Advanced Technologies:** The integration of advanced technologies, such as artificial intelligence (AI), machine learning, and the Internet of Things (IoT), will further enhance project management practices. AI can be used to analyze data and predict project outcomes, while IoT devices can provide real-time monitoring of construction sites, improving safety and efficiency. As these technologies become more accessible, construction firms that embrace them will gain a competitive advantage.



Construction firms that adopt sustainable practices will not only meet regulatory requirements but also attract environmentally conscious investors.

**3. Workforce Development and Training:** The successful implementation of digital tools requires a skilled workforce that is proficient in using these technologies. As the construction industry evolves, there will be a growing emphasis on workforce development and training initiatives. Governments, educational institutions, and industry stakeholders must collaborate to provide training programs that equip workers with the necessary digital skills. By investing in workforce development, the construction sector can ensure a skilled labor pool that is prepared to meet the demands of the future.





## Conclusion: Summary of Key Takeaways and Future Directions for the East African Construction Industry

The East African construction industry is currently experiencing a remarkable boom, characterized by rapid growth, significant investments, and an urgent need for infrastructure development. This surge is driven by a combination of factors, including urbanization, government initiatives, and the increasing demand for housing and public services. As the region continues to evolve, several key takeaways emerge, along with future directions that will shape the industry.

**Rapid Urbanization and Infrastructure Demand:** East Africa is witnessing unprecedented urbanization, with millions migrating to cities in search of better opportunities. This trend has created a pressing need for infrastructure, including housing, transportation, and utilities. Governments are prioritizing infrastructure development to accommodate this growth and improve living standards.

**Government Initiatives and Investment:** National development plans, such as Kenya's Vision 2030 and Uganda's National Development Plan, highlight the commitment of governments to enhance infrastructure. These initiatives are supported by significant public investments and efforts to attract foreign direct investment (FDI) to finance critical projects.

**Public-Private Partnerships (PPPs):** PPPs have emerged as a vital mechanism for financing and executing infrastructure projects. By leveraging private sector expertise and capital, governments can address funding gaps and enhance project delivery. Successful PPPs, such as the Nairobi-Mombasa Standard Gauge Railway, demonstrate the potential for collaboration to deliver critical infrastructure efficiently.

**1. Emphasis on Sustainability and Innovation:** The construction boom is accompanied by a growing emphasis on sustainability and innovation. As awareness of environmental issues increases, both investors and consumers are seeking projects that prioritize ecofriendly materials and energy-efficient designs. The adoption of digital tools and technologies is also transforming project management practices, enhancing efficiency and collaboration.

**2. Challenges and Opportunities:** Despite the positive outlook, the construction industry faces challenges, including labor shortages, rising material costs, and regulatory hurdles. Addressing these challenges will require concerted efforts from governments, industry stakeholders, and educational institutions to invest in workforce development, streamline regulatory processes, and enhance access to financing.

**Future Directions for the Industry**  
Looking ahead, the East African construction industry must focus on several key areas to sustain its growth and address emerging challenges:

**1. Strengthening Regulatory Frameworks:** Establishing clear and supportive regulatory frameworks will be essential for creating a favorable environment for construction. Streamlining processes for obtaining permits and licenses, reducing bureaucratic inefficiencies, and enhancing transparency will encourage investment and facilitate timely project execution.

**2. Investing in Workforce Development:** The industry requires a skilled workforce to meet the demands of ongoing and future projects. Investing in training and education initiatives is crucial for addressing labor shortages and ensuring that workers possess the necessary skills to thrive in the industry.

## The world's most complete range of mineral processing valves ...

Outstanding valve performance in abrasive, corrosive and scaling slurries.



**INSAMCOR**



**RF  
VALVES**



**Saunders®**

**AVENG  
MANUFACTURING  
DFC**

32 Lincoln Road, Industrial Sites, Benoni South  
PO Box 5064, Benoni South 1502, Republic of South Africa.  
Tel: +27 11 748-0200, Fax: +27 11 421-2749  
E-mail: [dfc@dfc.co.za](mailto:dfc@dfc.co.za), [www.dfc.co.za](http://www.dfc.co.za)

THRUH INDUSTRIAL - DFC M1208K



# YOU CREATE THE VISION WE CREATE THE BRICK

DISCOVER THE POSSIBILITIES.



Corobrik's clay face brick & paving range offers you versatility in design & durability that lasts a lifetime.



[www.corobrik.co.za](http://www.corobrik.co.za) | [info@corobrik.co.za](mailto:info@corobrik.co.za)